

DOUBLE FLANGED TYPE S46



DOUBLE FLANGED TYPE S46, BONDED LINER

Size DN40 to DN1200

Design EN593

Face to face acc. EN 558.1 series 13

Flange connections DIN PN6-10-16-25

ANSI B 16.5 Cl. 150#

JIS B 2211 5K, 10K

Temperature range -40 / + 250 °C

Various pressure ratings up to 25 bar

Top flange according ISO 5211

Vacuum to 1*10⁻³ 0.2 Torr absolute

DOUBLE FLANGED TYPE S46

BARE SHAFT

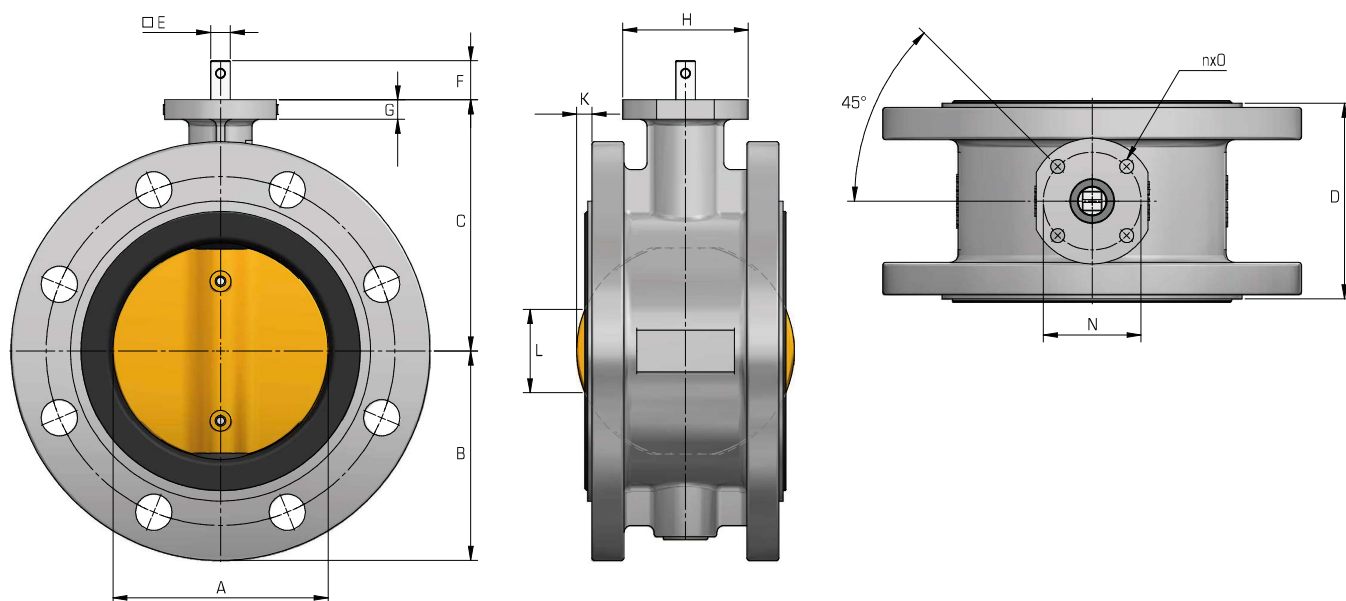

Standard available materials:

Body	Disc	Shaft	Seat
------	------	-------	------

EN-JS1030	BS1400 AB2	SS 1.4122	NBR
A216 WCB	EN-JS1030	SS 431	EPDM
SS 1.4408	SS 1.4408	SS 1.4462	Viton
BS1400 AB2	SD 2507	SD F53	Silicone

DN	NPS	øA	E	F	B	C	øH	D	N (PCD) (ISO 5211)	n x Ø	G	L	K	Weight +/-kg
40	1½"	40	11	25	61	113	90	106	ø70 (F07)	4 x ø9	12	NA	NA	7,5 kg
50	2"	52	11	25	67	118	90	108	ø70 (F07)	4 x ø9	12	NA	NA	8 kg
65	2½"	68	11	25	74	126	90	112	ø70 (F07)	4 x ø9	12	NA	NA	8,8 kg
80	3"	82	11	25	82	133	90	114	ø70 (F07)	4 x ø9	14	NA	NA	10 kg
100	4"	104	11	25	99,5	147	90	127	ø70 (F07)	4 x ø9	14	NA	NA	13,1 kg
125	5"	127	14	28	111,5	160	90	140	ø70 (F07)	4 x ø9	14	NA	NA	18 kg
150	6"	151	14	28	134	180	90	140	ø70 (F07)	4 x ø9	14	56	5,4	23,1 kg

DOUBLE FLANGED TYPE S46

BARE SHAFT

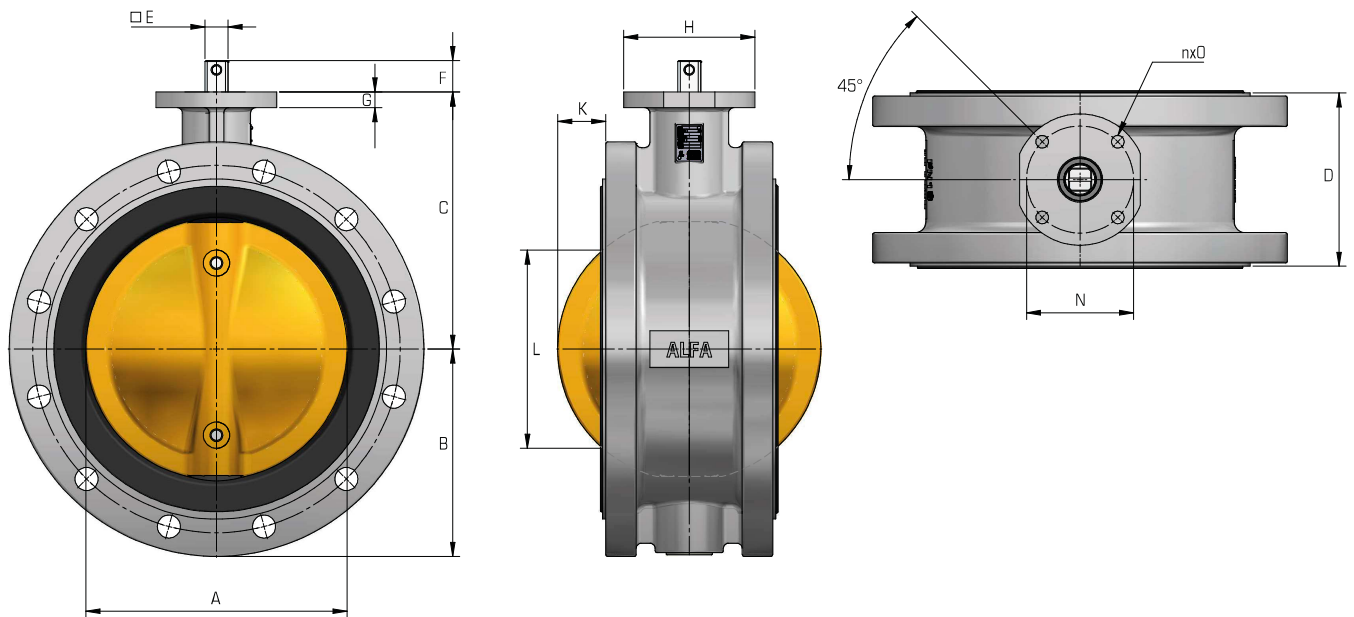

Standard available materials:

Body	Disc	Shaft	Seat
EN-JS1030	BS1400 AB2	SS 1.4122	NBR
A216 WCB	EN-JS1030	SS 431	EPDM
SS 1.4408	SS 1.4408	SS 1.4462	Viton
BS1400 AB2	SD 2507	SD F53	Silicone

DN	NPS	øA	E	F	B	C	øH	D	N (PCD) (ISO 5211)	n x Ø	G	L	K	Weight +/-kg
200	8"	201	17	28	172	204	90	152	ø70 (F07)	4 x ø9	14	132	25	43 kg
250	10"	252	22	30	203	245	125	165	ø102 (F10)	4 x ø11	15	190	43	52 kg
300	12"	304	22	30	223	270	125	178	ø102 (F10)	4 x ø11	15	246	63	77 kg

DOUBLE FLANGED TYPE S46

BARE SHAFT

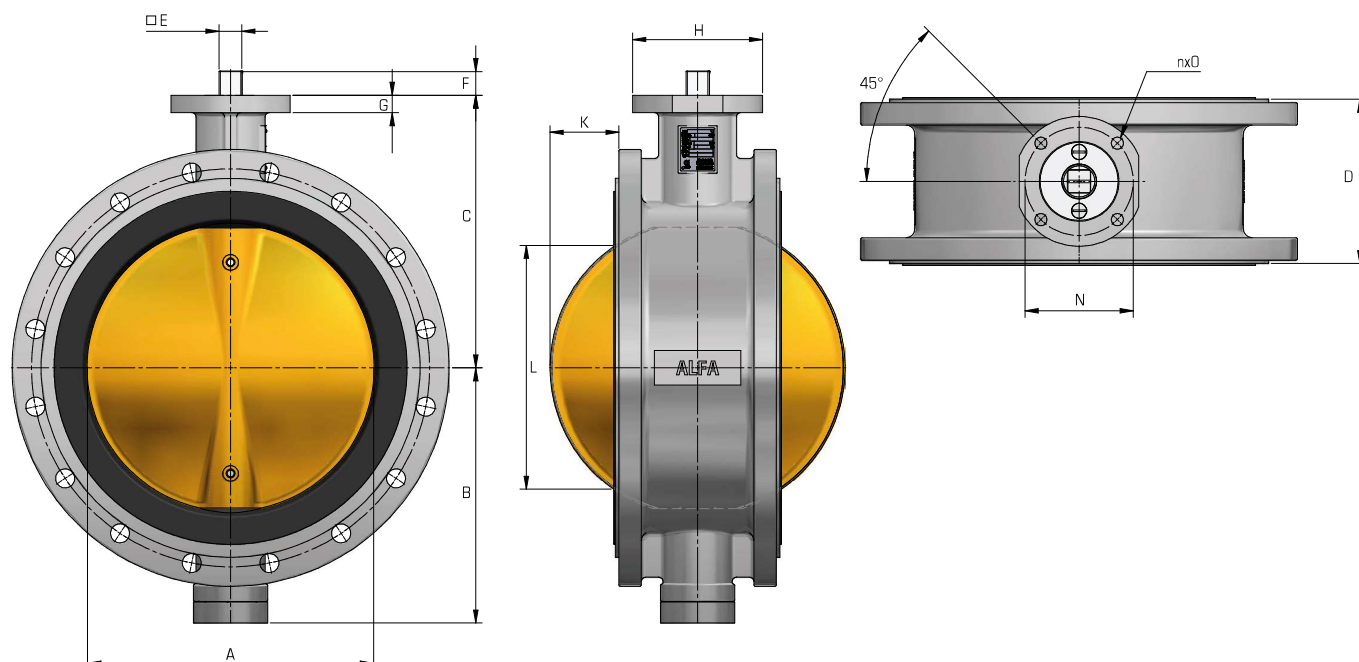

Standard available materials:

Body	Disc	Shaft	Seat
------	------	-------	------

EN-JS1030	BS1400 AB2	SS 1.4122	NBR
A216 WCB	EN-JS1030	SS 431	EPDM
SS 1.4408	SS 1.4408	SS 1.4462	Viton
BS1400 AB2	SD 2507	SD F53	Silicone

DN	NPS	øA	E	F	B	C	øH	D	N (PCD) (ISO 5211)	n x Ø	G	L	K	Weight +/-kg
350	14"	336	27	29	282	315	150	190	ø125 (F12)	4 x ø14	20	277	73	95 kg
400	16"	397	27	29	307	350	150	216	ø125 (F12)	4 x ø14	20	332	90	101 kg

DOUBLE FLANGED TYPE S46

BARE SHAFT

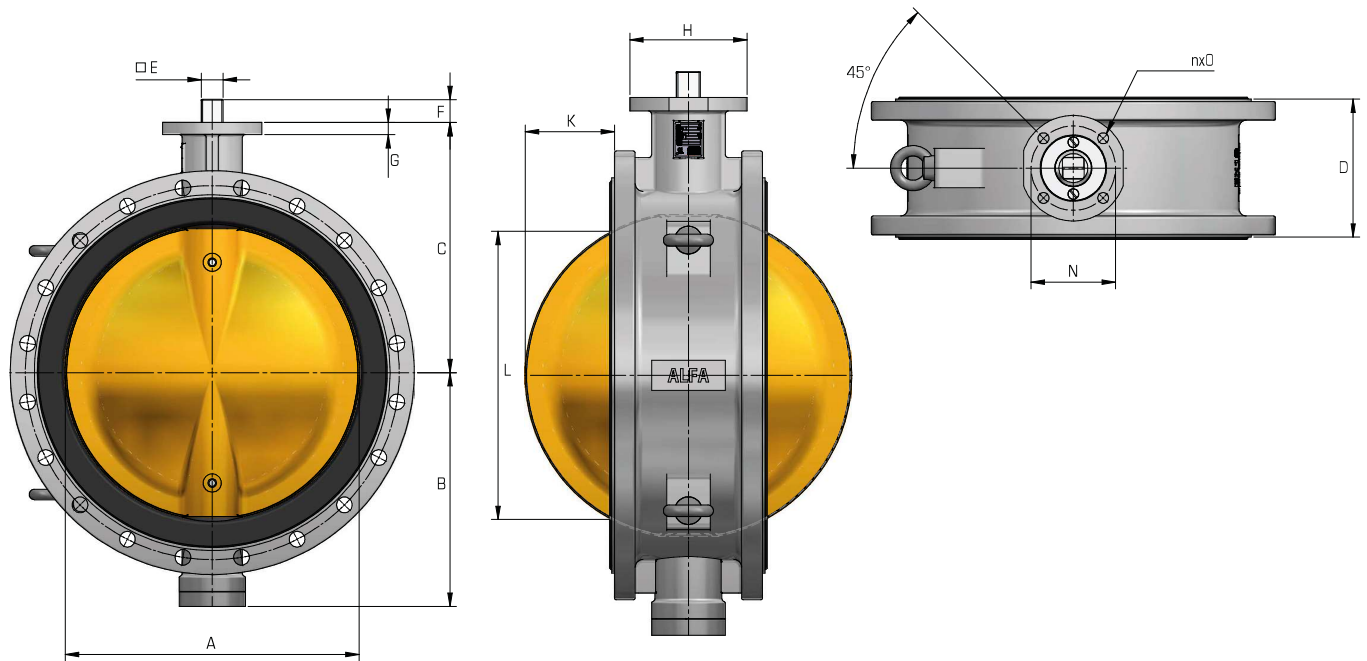

Standard available materials:

Body	Disc	Shaft	Seat
EN-JS1030	BS1400 AB2	SS 1.4122	NBR
A216 WCB	EN-JS1030	SS 431	EPDM
SS 1.4408	SS 1.4408	SS 1.4462	Viton
BS1400 AB2	SD 2507	SD F53	Silicone

DN	NPS	øA	E	F	B	C	øH	D	N (PCD) (ISO 5211)	n x Ø	G	L	K	Weight +/-kg
450	18"	447	36	38	352	375	175	222	ø140 (F14)	4 x ø18	20	388	112	154 kg
500	20"	497	36	38	387	415	175	229	ø140 (F14)	4 x ø18	20	441	134	170 kg
600	24"	601	46	48	452	465	210	267	ø165 (F16)	4 x ø22	25	538	167	231 kg

DOUBLE FLANGED TYPE S46

BARE SHAFT

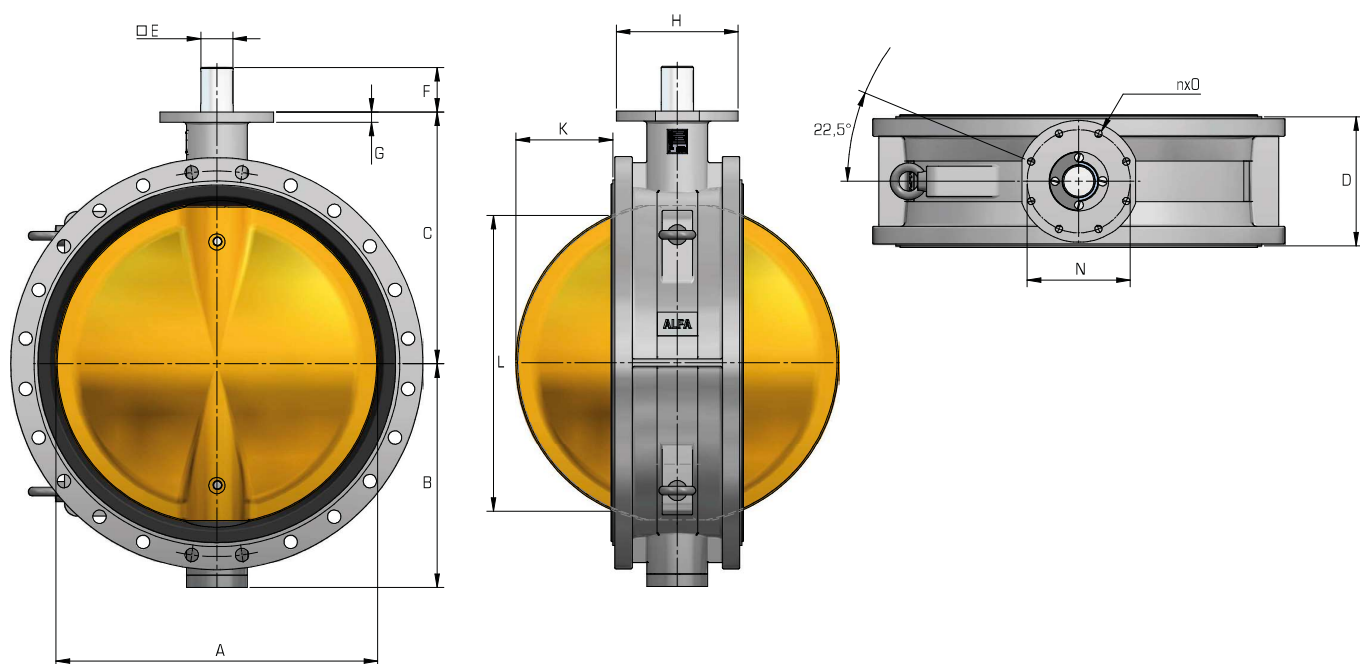

Standard available materials:

Body	Disc	Shaft	Seat
------	------	-------	------

EN-JS1030	BS1400 AB2	SS 1.4122	NBR
A216 WCB	EN-JS1030	SS 431	EPDM
SS 1.4408	SS 1.4408	SS 1.4462	Viton
BS1400 AB2	SD 2507	SD F53	Silicone

DN	NPS	øA	E	F	B	C	øH	D	N (PCD) (ISO 5211)	n x Ø	G	L	K	Weight +/-kg
700	28"	689	ø70	110	489	555	210	292	ø165 (F16)	4 x ø22	25	624	198	365 kg
800	32"	790	ø80	120	549	620	300	318	ø254 (F25)	8 x ø18	30	723	236	440 kg
900	36"	889	ø90	120	614	675	300	330	ø254 (F25)	8 x ø18	30	825	279	671 kg
1000	40"	986	ø90	120	664	740	300	410	ø254 (F25)	8 x ø18	30	897	288	990 kg
1100	44"	1073	ø105	120	740	800	350	410	ø298 (F30)	8 x ø22	40	942	332	1180 kg
1200	48"	1174	ø110	160	802	875	350	470	ø298 (F30)	8 x ø22	40	1075	352	1440 kg